

Čtvrť Emila Kolbena, 2.2 etapa

Alfred - budova A

BA20711

2 + KK / 7.NP

plocha dle NV č. 366/2013 Sb.

53,9 m²

užitná plocha celkem

51,1 m²

plocha balkonu

8,8 m²

čtvrť emila kolbena

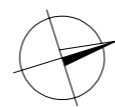
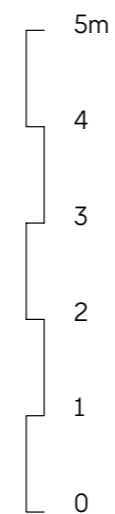
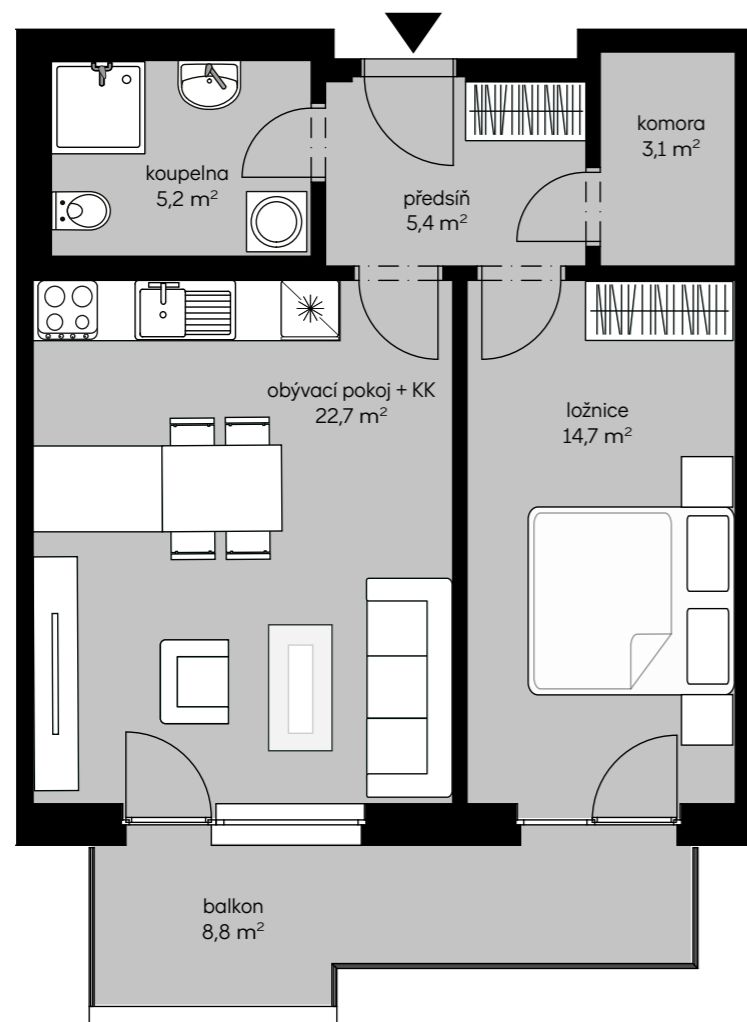

pohled východní

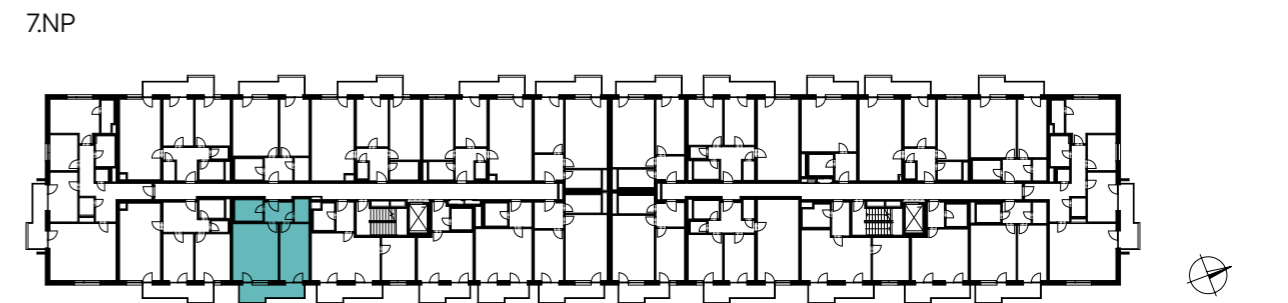

schéma podlaží